

LED PANEL LIGHT

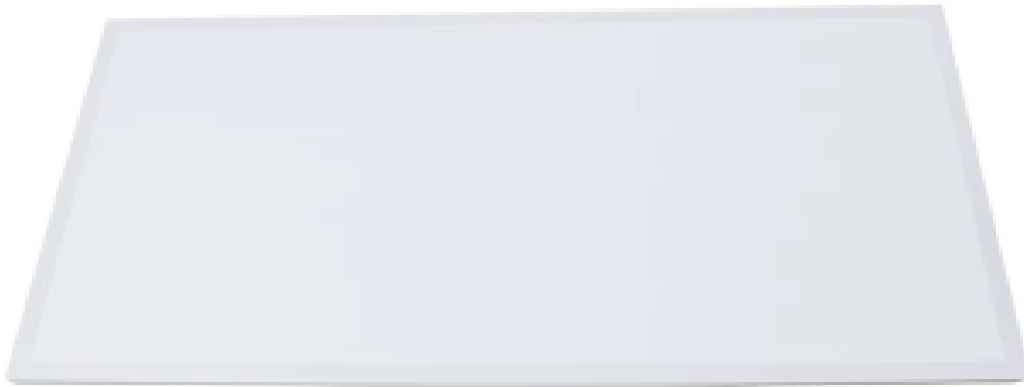
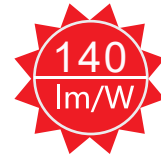

Features:

Super slim and efficient design
high light efficient and energy saving
Special heat treatment & Long life-span
Environmental friendly

Certificates



A: Technical Specification

Item	Lumen	Size(mm)	Lumen Efficiency	CCT	Voltage	Beam Angle	PF	CRI	Material
ULPL60120-48W	6720lm	595*1195*35mm	140lm/W	5000K	AC100-240V 50/60Hz	120°	> 0.9	Ra≥80	AL+PC

Application

This product is suitable for office, hall, family, hotel, conference room, factory or office, commercial use, residential or public facilities, school, hospital lights.



Dimension (Unit:mm)

Notes

- 1.All dimension units are millimeters
- 2.All dimension tolerance is ± 0.5 mm unless otherwise noted

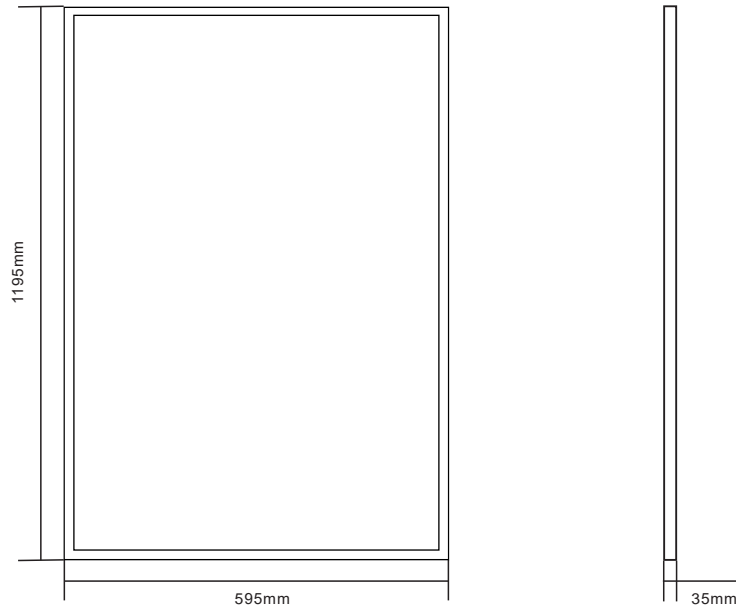

Safety / Information

- 1.Please make sure cut off the power before installation.
- 2.Please take care of water,electric shock and vibration.
- 3.Please use the panel with standard working voltage,any other voltage is not allowed;
- 4.Indoor use only;
- 5.Please read this manual carefully before using.



Packing information

Model NO:	Package	Size (mm)	QTY/PCS	Carton GW (KG)
ULPL60120-48W	Box size	1215*80*615mm	2	8



Installation instruction

1.Imbedding Installation:

Method.1

- 1.Take all accessories out of the bag,using spring accessories and lug with matched screws.
- 2.Fix lug with two screws as shown then fix spring accessories with screws in the holes of lug.
- 3.Assemble the remaining three springs as the same method then insert panel into ceiling.
Finish the installation.



Method.2

- 1.Cut an open hole on the ceiling where the panel light will be installed.
- 2.Imbeded the panel light inner the open hole.
- 3.Connecting the power cable to commercial power.

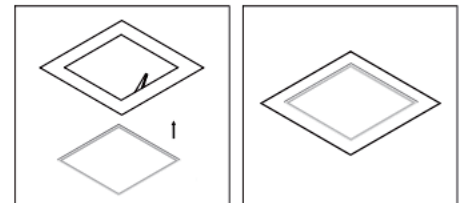

2.Surface Mounting Installation:

- 1.Assemble one “frame and two “b” frames with screws,one side isn’t sealed as shown (with the direction of the screw holes up) G
- 2.Fix the frame assembled in “1” on the ceiling,insert panel along two “b” frames, fix the remaining frame by screws,finish the installation.

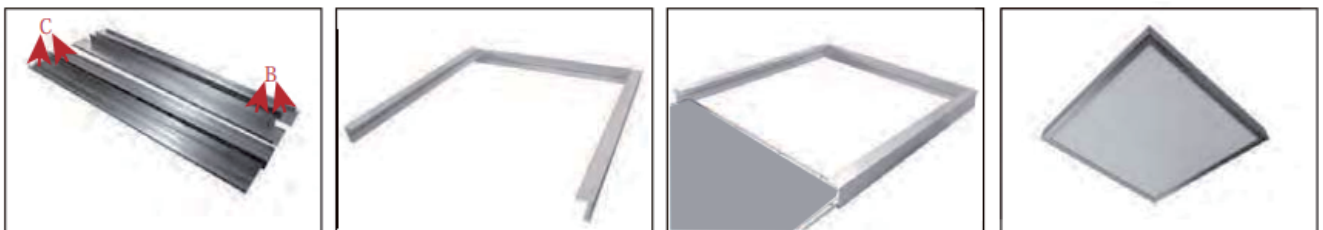

2.Suspending Installation:

- 1.Take all accessories out of the bag,using lug with matched screws together.
- 2.Screw off the bolt of the hanging rope.
- 3.Fix lug with two screws as shown then hang buckle buckled into the holes of lug (as the location figure out by red circle).
- 4.When four hanging buckles are buttoned,adjusting the hanging rope, making the panel lights in a Harizontal state.
- 5.Fix hanging rope with matched bolt in “1” to the ceiling,finish the installation.

